

Statement of reason

These proposals are to facilitate the traffic movements accessing/leaving the New Welsh Medium school, Farm, Garden Centre & Care Home within the school site.

The eastern access road is substandard for two way traffic. By making the eastern access one way it enables a contraflow cycle way to be provided and entry from the A4139 Bush Hill will be prohibited.

Although the route through the school site is not adopted highway it does have full public access and therefore these movements / prohibitions are to be supported by a TRO.

**THE COUNTY OF PEMBROKE (WELSH MEDIUM SCHOOL ACCESS ROAD, PEMBROKE)
(ONE WAY TRAFFIC (EXCEPT PEDAL CYCLES)) & PROHIBITION OF
LEFT & RIGHT TURN (A4139 BUSH HILL) ORDER 2024**

NOTICE is hereby given that Pembrokeshire County Council (“the Council”) in exercise of its powers under the Road Traffic Regulation Act 1984 (As amended) and of all other enabling powers, intends to make the above order, the effects of which are as follows:

- i) To permanently prohibit all vehicles except pedal cycles from proceeding along the unnamed eastern access road, from its junction with Bush Hill (A4139) to the junction with the internal connecting unnamed southbound road from the Henry Tudor School, other than in an Eastbound direction.
- ii) To permanently prohibit all vehicles from proceeding in a northbound direction on the unnamed road, between its junction with the unnamed eastern access road to the mini roundabout.
- iii) To permanently establish a contraflow cycle lane between the junction with Bush Hill to the junction with the unnamed southbound connecting road from the Henry Tudor School site.
- iv) To prohibit the left turn movement from the A4139 Bush Hill (Northbound) on to the unnamed eastern access road
- v) To prohibit the right turn movement from the A4139 Bush Hill (Southbound) onto the unnamed eastern access road

Full details are contained in the draft Order, which together with a map showing the length of road affected, may be examined online at www.pembrokeshire.gov.uk/traffic-regulation-orders

Any objection or representation in respect of the above proposals, together with the grounds on which it is made, by either completing the online feedback form, or, in writing to the undersigned by the 5th day of June 2024. Please quote: WMS OW

Dated this 15th day of May 2024

Darren Thomas

Head of Infrastructure & Environment

Pembrokeshire County Council

**THE COUNTY OF PEMBROKE (WELSH MEDIUM SCHOOL ACCESS ROAD,
PEMBROKE) (ONE WAY TRAFFIC (EXCEPT PEDAL CYCLES) & PROHIBITION
OF LEFT & RIGHT TURN (A4139 BUSH HILL) ORDER 2024**

THE PEMBROKESHIRE COUNTY COUNCIL (Hereinafter referred to as “the Council”) in exercise of its powers under sections 1(1), 2(1) to (3) and 4(2) of and Part IV of Schedule 9 to the Road Traffic Regulations Act 1984 (“the Act”) and of all other enabling powers and after consultation with the Chief Officer of the Police in accordance with Part III of Schedule 9 to the Act, Hereby make the following Order.

1. No person shall, except upon the direction or with the permission of a police constable in uniform or qualified Traffic Management Operative under instruction, cause or permit any Motor Vehicle to travel along the lengths of road set out in the Schedule 1 to this Order
2. No person shall, except upon the direction or with the permission of a police constable in uniform or qualified Traffic Management Operative under instruction, cause or permit any Motor Vehicle to travel along the lengths of road set out in the Schedule 2 to this Order
3. The prohibitions and restrictions imposed by this Order shall be in addition to and not in derogation from any restriction or requirement imposed by any regulations made or having effect as if made under the Act or by or under any other enactment.
4. This order may be cited as “The County of Pembroke (Welsh Medium School Access Road, Pembroke) (One Way Traffic (Except Pedal Cycles)) & Prohibition Of Left & Right Turn (A4139 BUSH HILL) Order 2024 and shall come into operation on the ** day of **** 2024

GIVEN under the Common Seal of the Pembrokeshire County Council this **th day of **** Two thousand and Twenty Four.

THE COMMON SEAL of **PEMBROKESHIRE**

COUNTY COUNCIL was hereunto affixed

in the presence of:-

Authorised Signatory

SCHEDULE 1

(PROHIBITION OF DRIVING)

Unnamed Eastern Access Road	To permanently prohibit all vehicles except pedal cycles from proceeding along the unnamed eastern access road, from its junction with Bush Hill (A4139) to the junction with the internal connecting unnamed southbound road from the Henry Tudor School, other than in an Eastbound direction.
Unnamed internal road	To permanently prohibit all vehicles from proceeding in a northbound direction on the unnamed road, between its junction with the unnamed eastern access road to the mini roundabout.

SCHEDULE 2

(PROHIBITION OF TURNING)

A4139	To prohibit the left turn movement from the A4139 Bush Hill (Northbound) onto the unnamed eastern access road
A4139	To prohibit the right turn movement from the A4139 Bush Hill (Southbound) onto the unnamed eastern access road.

100
Millimetres
0 10

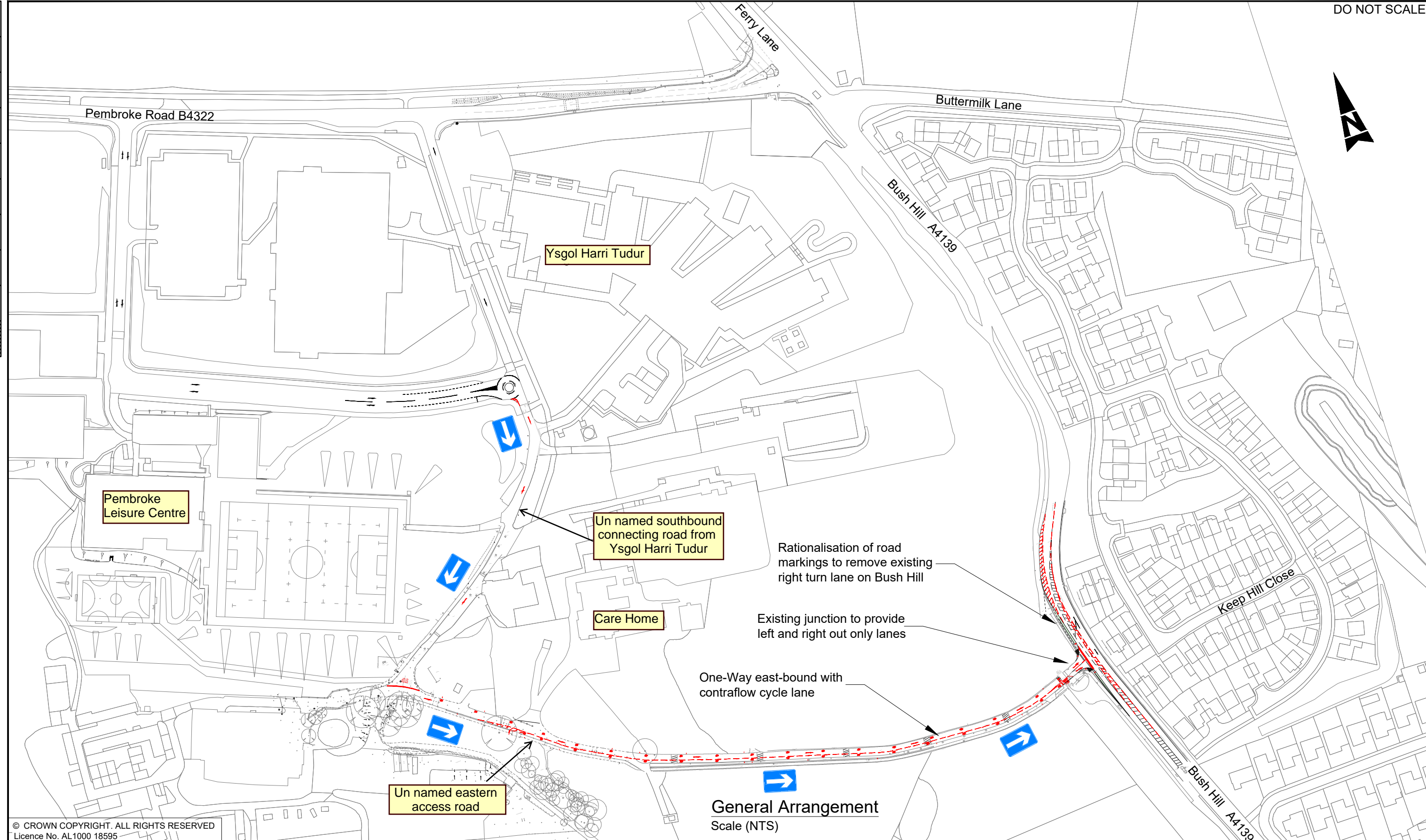

General Arrangement
Scale (NTS)

© CROWN COPYRIGHT. ALL RIGHTS RESERVED
Licence No. AL1000 18595

Key:	
	Existing road layout
	Proposed new road layout
	Indicates new One Way route

Notes:	
1. Preliminary design only - Subject to agreement with PCC	

SAFETY, HEALTH AND ENVIRONMENTAL INFORMATION					
In addition to the hazards/risks normally associated with the types of work detailed on this drawing, note the following:					
CONSTRUCTION					
NONE					
MAINTENANCE/CLEANING					
NONE					
DECOMMISSIONING/DEMOLITION					
NONE					
It is assumed that all works will be carried out by a competent contractor working, where appropriate, to an approved method statement					
Rev.	Date	Description	By	CHK'd	App'd
P1	21.08.23	DRAWING CREATED	AE	BH	GM

FOR INFORMATION		S2		Project Title	
ATKINS		No. 2, Capital Quarter Tyndall Street Cardiff Wales CF10 4BZ		PEMBROKE WMPS	
Copyright © Atkins Limited (2021)		Tel: +44 (0)2920 485159 Fax: +44 (0)2920 485138 www.atkinsglobal.com		Drawing Title	
MORGAN SINDALL GROUP PLC		Client		PROPOSED ACCESS STRATEGY	
Scale	1:2000	Designed	AE	Drawn	AE
Original Size	A3	Date	21.08.23	Checked	BH
		Date	22.09.21	Authorised	GM
		Date	22.09.21		
Drawing Number	WPMS	Originator	- ATK	Volume	- HGN -
HA PIN	PEMB	DR	- D -	5204792	Revision
		Type	Role	Number	P1